

Product Advantages and characteristics:

- Adjustable eccentric mechanism to ensure smooth changes in flow pulsation.
- Oil bath lubrication, long working life of driving parts.
- PVC, PVDF, stainless steel and other pump head materials are available.
- Various brands of whip electrodes and explosion-proof electrodes can be configured according to requirements.



Dimension Drawing

unit: mm

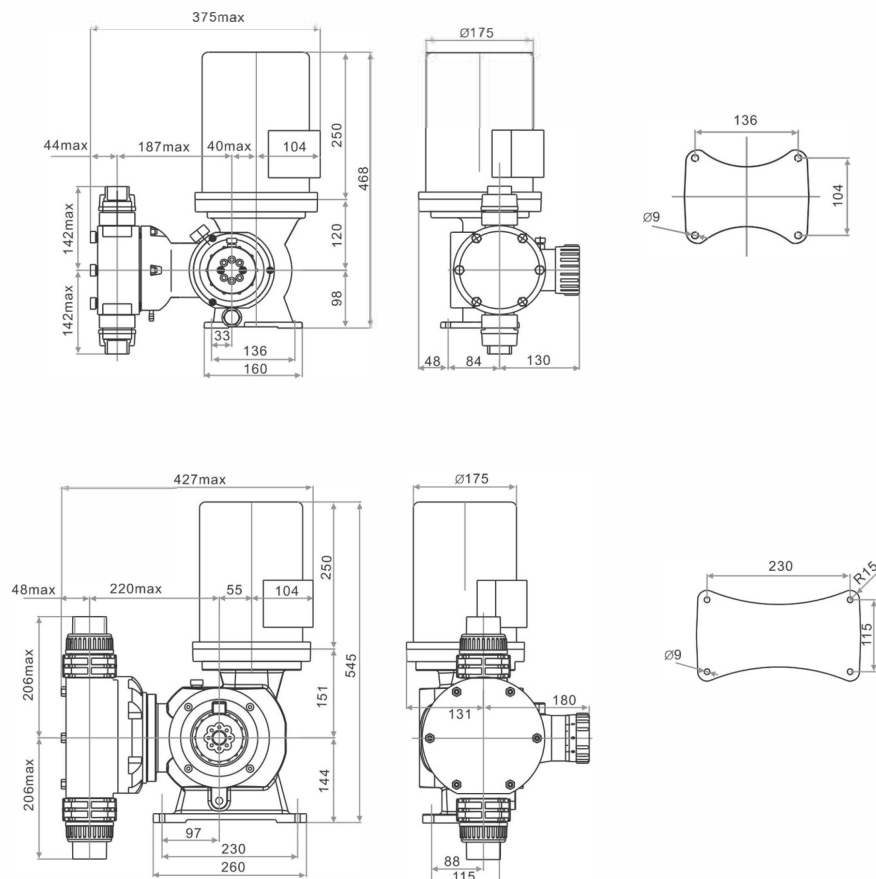

G Series Motor Driven Metering Pump

Technical Data				
Model	Pressure (Bar)	Flow (L/H)	Power (KW)	Connection Size
GM0005	12	4.5	0.37	DN15 Hard-tube
GM0010	12	9	0.37	DN15 Hard-tube
GM0025	12	25	0.37	DN15 Hard-tube
GM0050	10	50	0.37	DN15 Hard-tube
GM0090	7	85	0.37	DN15 Hard-tube
GM0120	7	120	0.37	DN15 Hard-tube
GM0170	7	170	0.37	DN15 Hard-tube
GM0240	7	240	0.37	DN15 Hard-tube
GM0330	5	315	0.55	DN25 Hard-tube
GM0400	5	400	0.55	DN25 Hard-tube
GM0500	5	500	0.55	DN25 Hard-tube
GB0080	10	82	0.75	DN15 Hard-tube
GB0180	10	167	0.75	DN15 Hard-tube
GB0250	10	237	0.75	DN25 Hard-tube
GB0350	10	334	0.75	DN25 Hard-tube
GB0450	10	416	0.75	DN25 Hard-tube
GB0500	7	464	0.75	DN25 Hard-tube
GB0600	7	583	0.75	DN25 Hard-tube
GB0700	3.5	656	0.75	DN25 Hard-tube
GB1000	3.5	946	0.75	DN40 Hard-tube
GB1200	3.5	1200	0.75	DN40 Hard-tube
GB1500	3	1500	1.5	DN40 Hard-tube
GB1800	3	1800	1.5	DN40 Hard-tube
GB2000	3	2000	1.5	DN40 Hard-tube

Liquid Ends Material		
Component	Standard	Optional
Pumphead	PVC	SS304、PVDF
Diaphragm	PTFE	—
Valve body	PVC	SS304、PVDF
Valve ball	Ceramics	SS304
Valve seat	PVC	SS304、PVDF
Valve spring	Hastelloy	—
Seals	FPM	PTFE